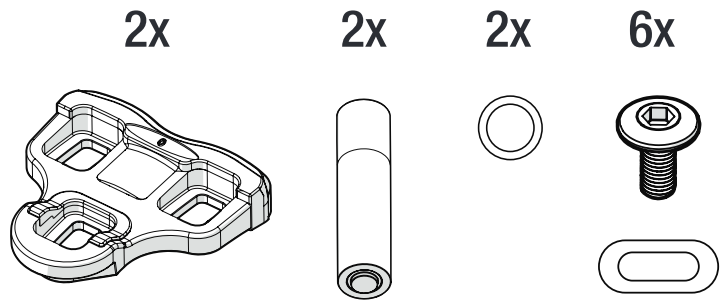

TABLE OF CONTENTS

| | |
|-----------|---|
| CHAPTER 1 | Pedal specifications |
| CHAPTER 2 | Installation and Removal <ul style="list-style-type: none"> a. Tension Adjustment |
| CHAPTER 3 | Pairing |
| CHAPTER 4 | Setting crank arm length |
| CHAPTER 5 | Calibration and manual zero <ul style="list-style-type: none"> a. Temperature Compensation |
| 1. | Battery replacement |
| 2. | Firmware |
| 3. | Precautions |
| 4. | Warranty |

PACKAGE CONTENTS

1. Right pedal
2. Left pedal
3. Pedal washers (pair)
4. Cleats (pair)
5. Cleat mounting hardware
6. Batteries (2-AAA)
7. Pedal Identification Card (not pictured)



TOOLS REQUIRED

- 2.5mm hex key
- 6mm hex key
- 8mm hex key (Allen wrench)

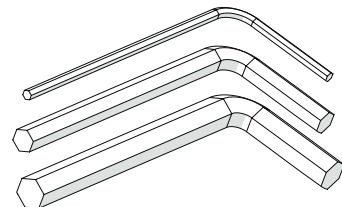

CHAPTER 1: PEDAL SPECIFICATIONS

| Specifications | |
|------------------------------|--|
| Weight | 398 grams per pair of pedals (without batteries) |
| Center of pedal | 53 mm from the crank to pedal center, Overall Center-Center: 249 mm w/ Shimano cranks, 250 mm w/SRAM cranks, 248.5 mm w/Campy cranks |
| Stack Height | 14 mm |
| Cornering angle | Specific lean angle determined by multiple factors. 25.5 degrees of lean (crank all the way down on the inside 175mm, 75mm BB drop, 147mm Q-factor, 700x23 tire size) |
| Tension Adjustment | Adjustable 6-20 Nm |
| Est. Battery Life | 60 hours |
| Normal Operating Temperature | -40°F to +140°F |
| Warranty | 2 years |